

FLEX-LOK™ Skirting System

Quickly and Easily Eliminate Load Point Spillage

The Flex-Lok™ Skirt Clamp is designed with versatility to meet the needs of any conveyor loading site—even severe, heavy loading applications. The exclusive design features a unique clamp pin with a captive wedge that can be locked in any position 360° around the pin. When properly installed, Flex-Lok ensures the skirt rubber will not rub on the belt and cause premature wear or gouging marks.



Optional limited space Mini Flex-Lok clamps available



Anti-vibration pin ensures pin remains locked

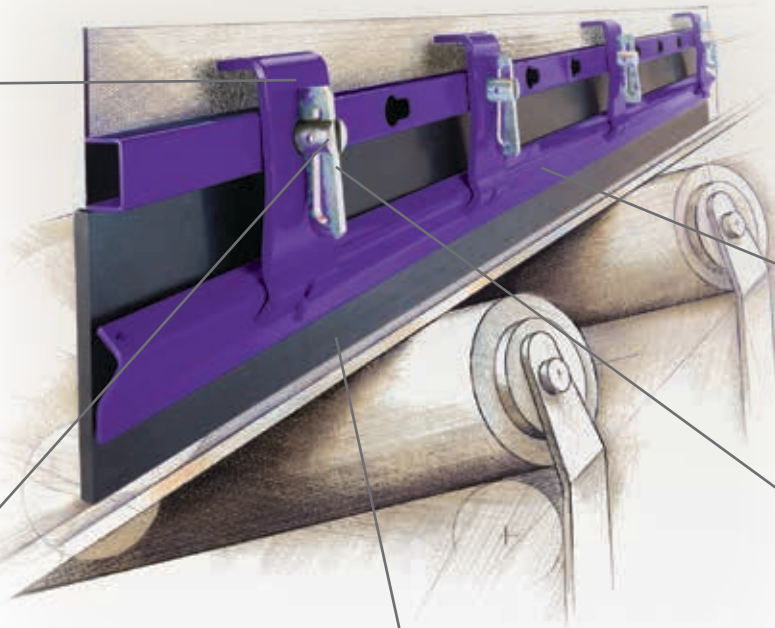

No hassle installation because skirt rubber restraining bar is held in place by clamp plates

Quick adjustment using the locking wedges on the clamp pins

Rubber thickness can vary from 8 to 25mm (5/16" - 1") on Standard and 8 to 16mm (5/16" - 5/8") on Mini

Features and Benefits

- **No belt damage.** With correct installation, the skirt rubber will not drag on the belt, causing premature wear or gouge marks in the belt cover. Such damage reduces belt cleaning efficiency and the life of the belt.
- **Safe surface access.** All installation and maintenance work can be done safely from the sides of the conveyor. Climbing into the chute to work on nuts and bolts is not required.
- **Long service life.** Flex-Lok Skirt Clamps are made of corrosion-protected components for tough duty. Replacement parts are available.

FLEX-LOK™ Skirting System

Ordering Information

Flex-Lok™ comes in standard size 2.0 M lengths and can be easily modified for shorter length requirements. The clamp plates and clamp pins can be placed in various positions along the clamp runner, even in the most restrictive environments. Extra plates and pins can be added for additional skirt rubber support at extremely heavy loading sites.

Ordering Information				
Description	Ordering Number	Item Code	Ordering Number	Item Code
Flex-Lok Skirt Clamp Complete	FLSC2000	71053	FLSC2000-S/S	A1436
Mini Flex-Lok Skirt Clamp Complete	FLSCM2000	71148	N/A	N/A

FINISH: Clamp plates and clamp bars are powder coated steel. Mounting channel is powder coated. Toggle pins are zinc passivated steel. Stainless Steel Mounting Channel is Keyhole design and does not come with cover strip and end caps. **Note:** Skirt rubber thickness range: 8 mm to 25 mm.

Replacement Parts				
Description	Ordering Number	Item Code	Ordering Number	Item Code
Toggle Pin	FLSC-TP	71056	FLSC-TP-S/S	A1437
Clamp Plate	FLSC-CP	71057	FLSC-CP-S/S	A1438
Mini Clamp Plate	FLSCM-CP	71140	N/A	N/A
Clamp Bar - 2000 mm	FLSC2000-CB	71061	FLSC-CB-S/S	A1439
Mounting Channel - 2000 mm	FLSC2000-MC	71059	FLSC2000MC-S/S	A1440

Parts Required for Flex-Lok Skirt Clamp Complete				
Item	Toggle Pin	Clamp Plate	Clamp Bar	Mounting Channel
FLSC2000	4	4	1	1
FLSCM2000	3	3	1	1
FLSC2000-316	4	4	1	1

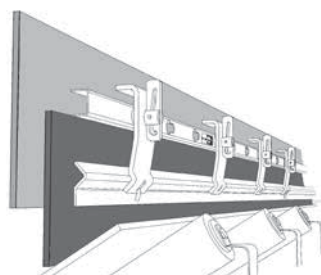

Standard

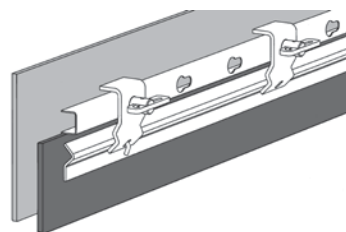

Mini

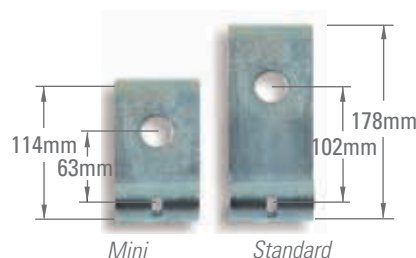

Mini

Standard

Additional Information

Check out our other Skirting Systems, like the RMC1 or Flex-Seal.

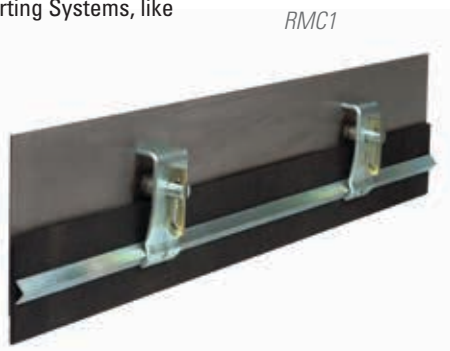

RMC1



Flex-Seal

Flexco (Aust.) Pty. Ltd • 10 Solent Circuit, Norwest • NSW, Australia, 2153 • Australia
Tel: 612-8818-2000 • Fax: 612-8824-6333 • E-mail: salesau@flexco.com

Visit www.flexco.com for other Flexco locations and products.

©2021 Flexible Steel Lacing Company. 06/10/21. For reorder: X2289

