

Roller Lacer® Gold Class™ Lacer Head Installation Instructions



Step 1: Open rollers all the way by turning the adjusting knob clockwise.

Step 2: Remove rollers.



Step 3: Position the head over the access holes in the bottom pan.



Step 4: Break loose all four jam nuts (top and bottom of head).



Step 5: Loosen top and bottom adjusting bolts until guide rollers clear extrusion channel (Step 5a - 5c).



Step 6: Remove head from extrusion.

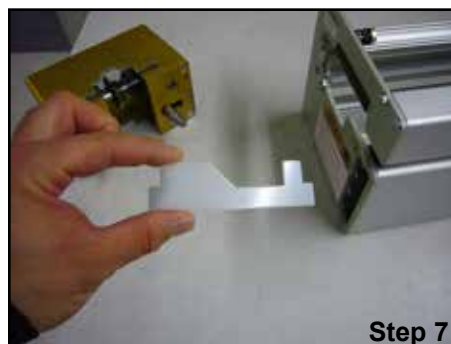

Step 7: If your lacer is equipped with the stabilizing wear strip, remove and discard it.

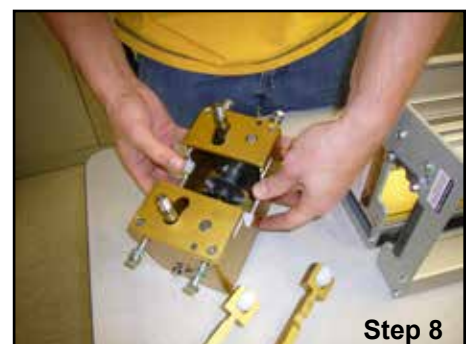

Step 8: Install the four stabilizing wear clips in position.



Step 9: If clevis bracket guide roller assemblies were removed, reinstall with the notch in the clevis bracket positioned over and facing the roller shaft.

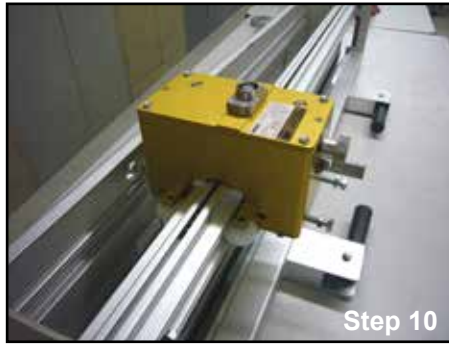

Step 10: Place head back on extrusion, positioning it so bottom adjusting bolts are over the access holes in bottom pan.

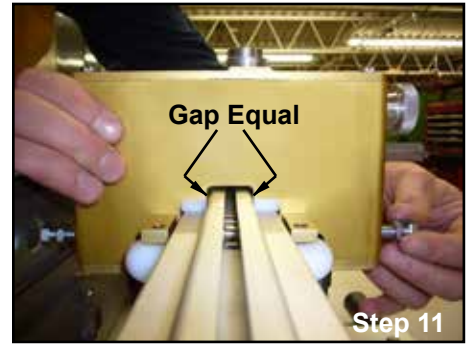

Step 11: Adjust the top bolts so that the gap between head and extrusion is equal.



Step 12: Finger tighten top and bottom adjusting bolts.



Step 14: Tighten the top and bottom lock nuts.

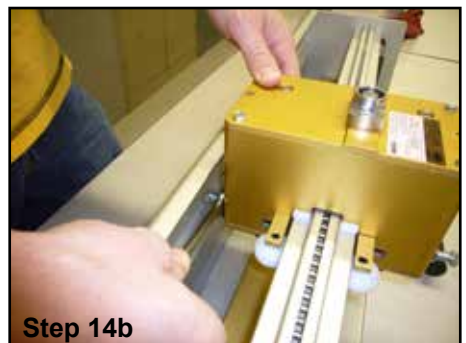

Step 14b:

Step 13: Test head for free movement up and down the lacer extrusion. If there is interference between the sprocket and the extrusion, repeat steps 10-12 until there is no interference.



Step 15: Reinstall rollers. While turning the roller, tighten the nut until the roller just starts to rub against the extrusion. Now back nut off about ¼ to ½ turn.



2525 Wisconsin Avenue • Downers Grove, IL 60515-4200 • USA
Tel: (630) 971-0150 • Fax: (630) 971-1180 • E-mail: info@flexco.com

Visit www.flexco.com for other Flexco locations and products.

©2018 Flexible Steel Lacing Company. Roller Lacer® is a registered trademark of Flexible Steel Lacing Company. 08/14/18. For reorder: X1534

