

## The All In One Splice Press

The Aero<sup>®</sup> 300 Press is revolutionizing the splicing industry due to its ease of use and quick cycle time. This air cooled press has all components integrated into the tool, allowing a user to simply plug it into electricity and it is ready for use.

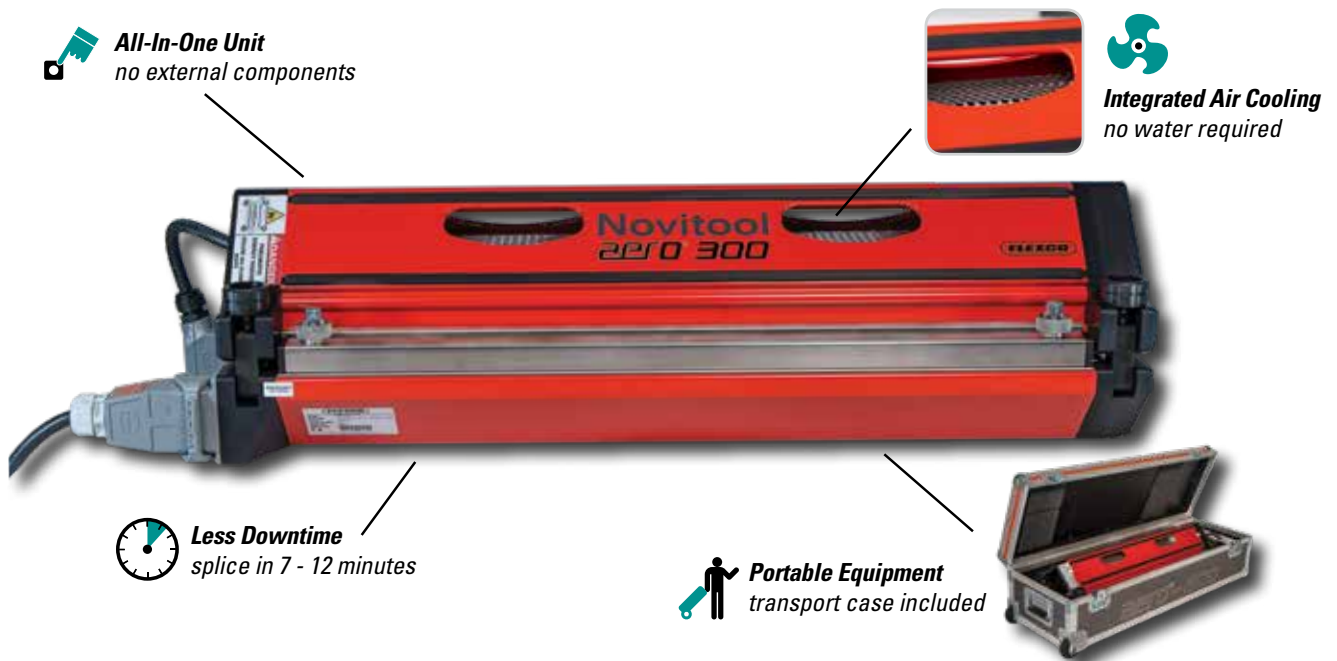

### Efficient & Fast Splicing - All In One.

Once taken from the transport case the unit is fully operational and ready to splice. There are no external systems such as water tanks and pumps needed. All functions and subsystems are integrated into the press. The press has an integrated air-cooling system which ensures that the belt is quickly cooled down. This increases the splice quality and the operating speed of the press. For most belt materials, the entire operation can be completed within 7 to 12 minutes.

### Aero<sup>®</sup> Specifications

The Aero<sup>®</sup> 300 operates on most common voltages and can be used for splicing thermoplastic belt materials up to a maximum 300 mm (12").

Aero <sup>®</sup> Tool Specifications	
Specifications	Aero 300
Effective length	305 mm / 12"
Effective width	130 mm / 5.1"
Weight lower part	14 kg / 32 lbs
Weight upper part	9 kg / 19 lbs
Total weight	23 kg / 51 lbs
Length	505 mm / 19.9"
Overall Height	220 mm / 8.5"
Max. pressure	2 Bar / 29 PSI
Max. temperature	200 °C / 390 °F
Dimensions for transport (L x W x H)	1000 x 430 x 380 mm (30 x 17 x 15")
Weight for transport	45 kg / 98 lbs
Power requirements	
1 phase 230 Vac	8.8 A
3 phase 230 Vac	4.4 A
3 phase 400 Vac+0	4.4 A
3 phase 460 Vac	4.4 A

## Quality, Smooth Splice

The wide platens with integrated cool zones prevent the top beam from sinking into the molten belt material under pressure. This results in an extremely flat splice which is desired by users.

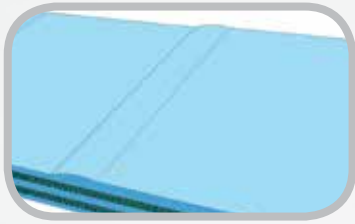

*Traditional splice*

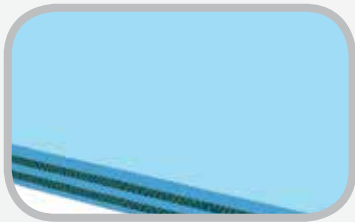

*Smooth splice with the Aero®*

Aero® Ordering Information	
Ordering Number	Item Code
AERO-300	08000

Note: Power cords are not included and must be ordered separately.  
Contact Customer Service for ordering information.

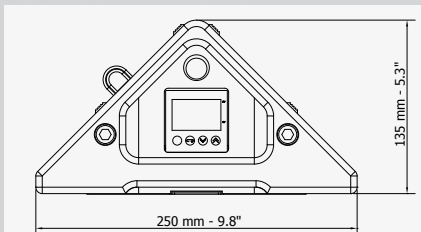
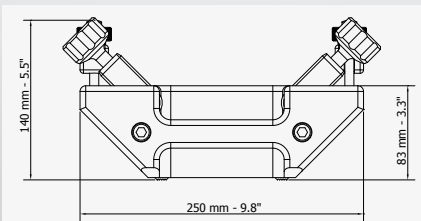

## NOVITool® AERO® 300 Portable Splice Press

### Easy to operate and excellent splice repeatability

The Aero® has two controllers. One for adjustment of temperature and time and one for setting the pressure generated by the built-in compressor. The material/splice specific pressure and temperature values are easily set and the splicing operation itself is fully automatic. The temperature controller has a scrolling display which navigates the user through the settings in clear text messages.

With two quick-clamping bars it is easy to position and fasten the material in the press. The clamping bars ensure that the material remains in position until the upper beam is clamped in place.

### Temperature control and cooling

With the Aero press, the user can achieve different splice temperatures for the upper and lower platen or use a single temperature for both platens. This function makes it easy to obtain improved splice results for belts with an asymmetric construction, or those with very thin thermoplastic coatings.

Unique programming features enable a more precise setting of the dwell time (down to seconds), an automatic dwell time countdown, and a preheating cycle. A controlled, stepped/preheating will provide better splice results with thicker or less heat conducting belt materials.

The splice platens have integrated cool zones on both sides of the heating zone. This will result in ultra smooth splices even for the most difficult belt materials. No inlays of glass fibre or metal are used which may cause pressure differences. This design results in:

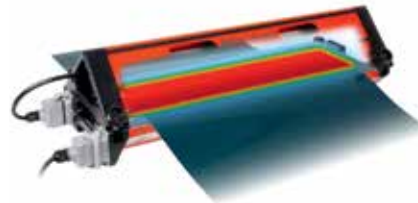

- No sinking of the hot splice plates into the molten belt material
- No bumps next to the splice
- Less shrinkage of the fingers
- Diminished shiny transition lines

With conventional systems, these malformations are often difficult to control, requiring process adjustments, trial runs, and a lot of craftsmanship. However, the Aero can be operated with minimal training, generating repeatable, high quality splices time after time.

Authorised Distributor:

240 Macpherson Road • #02-01 • Singapore 348574  
Tel: +65-6484-1533 • Fax: +65-6484-1531 • E-mail: [asiasales@flexco.com](mailto:asiasales@flexco.com)

Visit [www.flexco.com](http://www.flexco.com) for other Flexco locations and products.

©2016 Flexible Steel Lacing Company. Novitool® is a registered trademark. 08-09-19. For Reorder: X4517

