

Alligator® QUICK FIX™

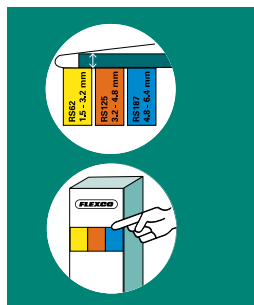

Verbinden der Bandenden

Das Verbinden von Bandenden am Montageort war nie einfacher. Mit Alligator® Quick Fix™ benötigt man nur einfache Werkzeuge, um in wenigen Minuten eine stabile Verbindung herzustellen. In der Packung finden Sie eine Schritt-für-Schritt-Anleitung.

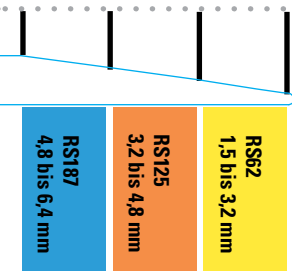

So funktioniert es:



www.flexco.com/quickfix

FLEXCO

Partners in Productivity



+

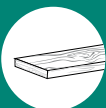

=



Wie ein Band verbunden wird

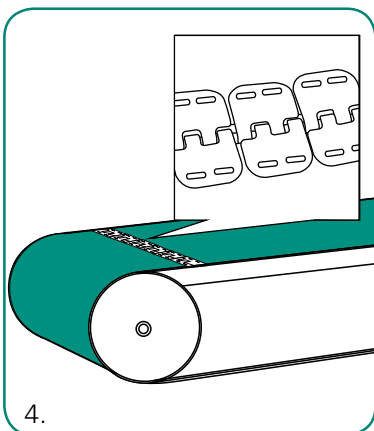
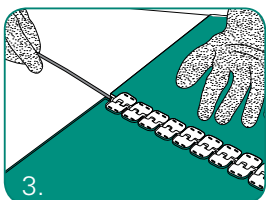
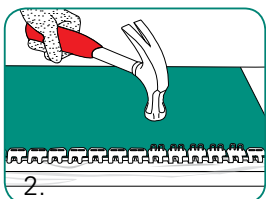
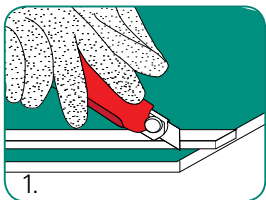

Bandstärke mm	Mindest-Trommeldurchmesser mm	Bandbreite mm	Bestellnummer	Artikelnummer	
RS62	1,5–3,2	50	300	RS62QF/300NC	50119
			600	RS62QF/600NC	50120
			900	RS62QF/900NC	50121
			1000	RS62QF/1000NC	50210
			1200	RS62QF/1200NC	50137
RS125	3,2–4,8	75	300	RS125QF/300NC	50138
			600	RS125QF/600NC	50139
			900	RS125QF/900NC	50140
			1000	RS125QF/1000NC	50211
			1200	RS125QF/1200NC	50141
RS187	4,8–6,4	100	300	RS187QF/300NC	50142
			600	RS187QF/600NC	50143
			900	RS187QF/900NC	50147
			1000	RS187QF/1000NC	50214
			1200	RS187QF/1200NC	50149

www.flexco.com

FLEXCO